

2023 MS4 Progress Report Grand Haven

General information

Were any new municipal facilities added to your jurisdiction in 2023 that have stormwater infrastructure? **No**

Did you identify or construct any new outfalls or points of discharge? **No**

Enforcement Actions

The enforcement response procedure and form to be filled out in case of an unauthorized discharge can be found in your Stormwater Management Plan (SWMP). SWMPs are saved under your community name [on LGROW's website](#).

Were there any enforcement actions taken in 2023? This includes fines, citations, stop work orders. **None**

Illicit Discharges

How many illicit discharges were detected in 2023? **None**

Explain each illicit discharge and action taken to investigate/clean up each discharge: **N/A**

Were all illicit discharges detected eliminated? **N/A**

How many illicit discharges led to enforcement action? **N/A**

Soil Erosion and Sedimentation Control (Part 91)

Were there any changes made to your SESC program in 2023? (ex. change in Part 91 status as an APA or MEA): **None**

Were there any issues identified in 2023 under the SESC program on construction sites under your jurisdiction? If so, please explain: **N/A**

Post Construction Control (Development and Redevelopment)

How many developments were approved under the new stormwater ordinance? **None**

Were any maintenance agreements signed? **No**

How are you tracking signed maintenance agreement requirements? **N/A**

Facilities

Were any new facilities that the municipality is responsible for added in the past few years? You can view your facility inventory under your community name [on LGROW's website](#) (Appendix 6 Facility Inventory). The bi annual stormwater facility inspection forms are attached.

Please attach any facility inspection forms completed in 2023.

Table 16. Structural Stormwater Controls Inspection and Maintenance Schedule					
Structural BMP	Inspection Frequency	Maintenance Frequency	Disposal	TSS Removal	2023 Inspection and Maintenance
Vegetated Swales	Weekly during the season	Weekly during the season	Landfill	Medium/High	Inspected Spring/Fall, functioning as designed.
Underground Storage Vault or Tanks	Annually	Annually	Landfill	Low	Functioning as designed. Inspected with catch basins.
Vegetated Buffer Strips	Annually	Annually	Landfill	Medium/Low	Functioning as designed. Maintained in summer.
Infiltration Basins or Trenches	Every 3 years	As needed, per inspection results	Landfill	High	Inspected with catch basins.
Oil/Water or Grit Separator	Annually	Annually	Landfill	High	Functioning as designed. Inspected annually, serviced as needed.

Street Sweeping

Did you perform street sweeping?

Yes No

Please submit a log of street sweeping, or invoices if you contracted this work out.

Catch Basin Cleaning

Please submit a log of catch basin inspections, cleaning, or invoices if you contracted this work out.

Did you inspect catch basins?

Yes No

How many? We inspect 1/3 of the City's catch basins per year. We cleaned 772 catch basins in 2023.

Road Work

During road, parking lot, sidewalk and right-of-way maintenance were BMPs implemented to prevent or reduce pollutant runoff during maintenance? **Regular street sweeping and regular inspections at the work area.**

Is the municipality responsible for any bridge maintenance? If so, were BMPs implemented to prevent or reduce pollutant runoff during maintenance? **Yes, one small bridge on 3rd Street. The bridge does not require regular maintenance. We did not do any maintenance work to the bridge in 2023**

Is the municipality responsible for any unpaved roads? If so, were BMPs implemented to prevent or reduce pollutant runoff for unpaved roads? **No**

Is the municipality responsible for any plowing and salting? If so, were BMPs implemented to prevent or reduce pollutant runoff during winter operations? Please explain. **We no longer use a sand chloride and salt mixture during low temperatures. We use a salt and liquid chloride pre wet solution. This helps reduce the amount of salt and sand entering the catch basins.**

Is the municipality responsible for washing vehicles (ex: trucks, police cars, school buses)? If so, were BMPs implemented to prevent or reduce pollutant runoff during washing? Please explain. **Yes, the City washes all of its own vehicles. We wash vehicles inside of our building and all drains are connected to the sanitary sewer system.**

Training

Was any training completed in 2023 that you would like to report on behalf of your staff to EGLE? (Conferences, seminars, or PDH's you wish to report for you or your staff.)

10/18/2023: Winter Maintenance Training-ROADS

BMP/activity		Maintenance Required?	Corrective Action Taken
Is the drive free from trackout of raw material (topsoil/sand/salt)?	<input checked="" type="checkbox"/> Yes <input type="checkbox"/> No	<input type="checkbox"/> Yes <input checked="" type="checkbox"/> No	
Garage			
Are non-stormwater discharges (e.g., wash water, dewatering) properly controlled?	<input checked="" type="checkbox"/> Yes <input type="checkbox"/> No	<input type="checkbox"/> Yes <input checked="" type="checkbox"/> No	
Are the Grit Separators/Oil Water Separators functioning properly?	<input checked="" type="checkbox"/> Yes <input type="checkbox"/> No	<input type="checkbox"/> Yes <input checked="" type="checkbox"/> No	
Are hazardous materials stored appropriately?	<input checked="" type="checkbox"/> Yes <input type="checkbox"/> No	<input type="checkbox"/> Yes <input checked="" type="checkbox"/> No	
Is Spill Kit present and stocked with spill materials?	<input checked="" type="checkbox"/> Yes <input type="checkbox"/> No	<input type="checkbox"/> Yes <input checked="" type="checkbox"/> No	
Oil Room			
Is oil room free of spills or leaks?	<input checked="" type="checkbox"/> Yes <input type="checkbox"/> No	<input type="checkbox"/> Yes <input checked="" type="checkbox"/> No	
Is Spill Kit present and stocked with spill materials?	<input checked="" type="checkbox"/> Yes <input type="checkbox"/> No	<input type="checkbox"/> Yes <input checked="" type="checkbox"/> No	
Parking Lot			
Free of trash and spilled automotive fluids	<input checked="" type="checkbox"/> Yes <input type="checkbox"/> No	<input type="checkbox"/> Yes <input checked="" type="checkbox"/> No	
Are vehicles parked outside free of spills and/or leaks?	<input checked="" type="checkbox"/> Yes <input type="checkbox"/> No	<input type="checkbox"/> Yes <input checked="" type="checkbox"/> No	
Overall General Housekeeping	<input type="checkbox"/> Good <input checked="" type="checkbox"/> Fair <input type="checkbox"/> Poor	<input type="checkbox"/> Yes <input checked="" type="checkbox"/> No	
Other Areas for Consideration:	None		

Non-Compliance

Describe any incidents of non-compliance not described above:

None

Grand Haven Stormwater Facility Inspection Report

General Information			
Location	DPW		
Date of Inspection	10/20/23	Start Time	8:00 AM
Inspector's Name(s)	Collin Such		
Inspector's Title(s)	Street Department Crew Leader		
Weather Information			
Weather at time of this inspection?			
<input type="checkbox"/> Clear <input checked="" type="checkbox"/> Cloudy <input checked="" type="checkbox"/> Rain <input type="checkbox"/> Sleet <input type="checkbox"/> Fog <input type="checkbox"/> Snowing <input type="checkbox"/> High Winds <input type="checkbox"/> Other: Temperature: 51°F			
Have any illicit discharges occurred since the last inspection? <input type="checkbox"/> Yes <input checked="" type="checkbox"/> No			
If yes, describe:			
Are there any illicit discharges at the time of this inspection? <input type="checkbox"/> Yes <input checked="" type="checkbox"/> No			
If yes, describe:			

BMP/activity		Maintenance Required?	Corrective Action Taken
Catch Basins			
Are storm drains clean and clear of debris?	<input checked="" type="checkbox"/> Yes <input type="checkbox"/> No	<input type="checkbox"/> Yes <input checked="" type="checkbox"/> No	
Are sumps less than 50% full of sediment?	<input checked="" type="checkbox"/> Yes <input type="checkbox"/> No	<input type="checkbox"/> Yes <input checked="" type="checkbox"/> No	
Are catch basins in good structural shape?	<input checked="" type="checkbox"/> Yes <input checked="" type="checkbox"/> No	<input checked="" type="checkbox"/> Yes <input type="checkbox"/> No	Sinkhole around front Catch Basin
Dumpsters			
Are dumpsters free from leaks?	<input checked="" type="checkbox"/> Yes <input type="checkbox"/> No	<input type="checkbox"/> Yes <input checked="" type="checkbox"/> No	
Are dumpsters covered?	<input checked="" type="checkbox"/> Yes <input type="checkbox"/> No	<input type="checkbox"/> Yes <input checked="" type="checkbox"/> No	
Raw Materials			
Are raw materials stored under cover, or in a place where they will not be released into the storm system?	<input checked="" type="checkbox"/> Yes <input checked="" type="checkbox"/> No	<input type="checkbox"/> Yes <input checked="" type="checkbox"/> No	Some Covered, Some are not

BMP/activity		Maintenance Required?	Corrective Action Taken
Is the drive free from trackout of raw material (topsoil/sand/salt)?	<input checked="" type="checkbox"/> Yes <input type="checkbox"/> No	<input type="checkbox"/> Yes <input checked="" type="checkbox"/> No	
Garage			
Are non-stormwater discharges (e.g., wash water, dewatering) properly controlled?	<input checked="" type="checkbox"/> Yes <input type="checkbox"/> No	<input type="checkbox"/> Yes <input checked="" type="checkbox"/> No	
Are the Grit Separators/Oil Water Separators functioning properly?	<input checked="" type="checkbox"/> Yes <input type="checkbox"/> No	<input type="checkbox"/> Yes <input checked="" type="checkbox"/> No	
Are hazardous materials stored appropriately?	<input checked="" type="checkbox"/> Yes <input type="checkbox"/> No	<input type="checkbox"/> Yes <input checked="" type="checkbox"/> No	
Is Spill Kit present and stocked with spill materials?	<input checked="" type="checkbox"/> Yes <input type="checkbox"/> No	<input type="checkbox"/> Yes <input checked="" type="checkbox"/> No	
Oil Room			
Is oil room free of spills or leaks?	<input checked="" type="checkbox"/> Yes <input type="checkbox"/> No	<input type="checkbox"/> Yes <input checked="" type="checkbox"/> No	
Is Spill Kit present and stocked with spill materials?	<input checked="" type="checkbox"/> Yes <input type="checkbox"/> No	<input type="checkbox"/> Yes <input checked="" type="checkbox"/> No	
Parking Lot			
Free of trash and spilled automotive fluids	<input checked="" type="checkbox"/> Yes <input type="checkbox"/> No	<input type="checkbox"/> Yes <input checked="" type="checkbox"/> No	
Are vehicles parked outside free of spills and/or leaks?	<input checked="" type="checkbox"/> Yes <input type="checkbox"/> No	<input type="checkbox"/> Yes <input checked="" type="checkbox"/> No	
Overall General Housekeeping	<input type="checkbox"/> Good <input checked="" type="checkbox"/> Fair <input type="checkbox"/> Poor	<input type="checkbox"/> Yes <input checked="" type="checkbox"/> No	
Other Areas for Consideration:			

Non-Compliance

Describe any incidents of non-compliance not described above:

OBJECTID * SHAPE *	CB_ID	OWNER	OUTFALL	GRATE	CONSTRUCTUR	INEX	CLEA	PREV CLEAN 1
1346 Point	CB772	CITY	GHC2804	<Null>	<Null>	<Null>		7/23/2023
505 Point	CB983	CITY	GHC2112	<Null>	<Null>	<Null>		7/19/2023
1240 Point	CB1251	CITY	GHC2106	<Null>	<Null>	<Null>		7/19/2023
1258 Point	CB1269	CITY	GHC2106	<Null>	<Null>	<Null>		7/19/2023
1264 Point	CB1275	CITY	GHC2112	<Null>	<Null>	<Null>		7/19/2023
1268 Point	CB1279	CITY	GHC2112	<Null>	<Null>	<Null>		7/19/2023
360 Point	CB654	CITY	GHC2804	<Null>	<Null>	<Null>		7/18/2023
361 Point	CB655	CITY	GHC2804	<Null>	<Null>	<Null>		7/18/2023
362 Point	CB656	CITY	GHC2804	<Null>	<Null>	<Null>		7/18/2023
363 Point	CB657	CITY	GHC2804	<Null>	<Null>	<Null>		7/18/2023
364 Point	CB658	CITY	GHC2804	<Null>	<Null>	<Null>		7/18/2023
365 Point	CB659	CITY	GHC2804	<Null>	<Null>	<Null>		7/18/2023
512 Point	CB990	CITY	GHC2112	<Null>	<Null>	<Null>		7/18/2023
518 Point	CB996	CITY	GHC2112	<Null>	<Null>	<Null>		7/18/2023
1220 Point	CB1232	CITY	GHC2112	<Null>	<Null>	<Null>		7/18/2023
1239 Point	CB1250	CITY	GHC2106	<Null>	<Null>	<Null>		7/18/2023
1241 Point	CB1252	CITY	GHC2106	<Null>	<Null>	<Null>		7/18/2023
1257 Point	CB1268	CITY	GHC2106	<Null>	<Null>	<Null>		7/18/2023
1259 Point	CB1270	CITY	GHC2106	<Null>	<Null>	<Null>		7/18/2023
1260 Point	CB1271	CITY	GHC2106	<Null>	<Null>	<Null>		7/18/2023
1274 Point	CB1285	CITY	GHC2112	<Null>	<Null>	<Null>		7/18/2023
1275 Point	CB1286	CITY	GHC2112	<Null>	<Null>	<Null>		7/18/2023
1644 Point	<Null>	<Null>	<Null>	<Null>	<Null>	<Null>		7/18/2023
1681 Point	CB1617	CITY	GHC2106	New	<Null>	<Null>		7/18/2023
174 Point	CB180	CITY	GHC2112	<Null>	<Null>	<Null>		7/17/2023
380 Point	CB778	CITY	GHC2804	<Null>	<Null>	<Null>		7/17/2023
764 Point	CB1375	CITY	GHC2108	<Null>	<Null>	<Null>		7/17/2023
1041 Point	CB478	CITY	GHC2111	<Null>	<Null>	<Null>		7/17/2023
1132 Point	CB566	CITY	GHC2112	<Null>	<Null>	<Null>		7/17/2023
1144 Point	CB578	CITY	GHC2112	<Null>	<Null>	<Null>		7/17/2023
1145 Point	CB579	CITY	GHC2112	<Null>	<Null>	<Null>		7/17/2023
1147 Point	CB581	CITY	GHC2112	<Null>	<Null>	<Null>		7/17/2023
1178 Point	CB776	CITY	GHC2804	<Null>	<Null>	<Null>		7/17/2023
1179 Point	CB777	CITY	GHC2804	<Null>	<Null>	<Null>		7/17/2023
1281 Point	CB1292	CITY	GHC2112	<Null>	<Null>	<Null>		7/17/2023
1466 Point	CB799	CITY	GHC2024	<Null>	<Null>	<Null>		7/17/2023
1898 Point	<Null>	<Null>	<Null>	<Null>	<Null>	<Null>		7/17/2023
513 Point	CB991	CITY	GHC2112	<Null>	<Null>	<Null>		7/13/2023
514 Point	CB992	CITY	GHC2112	<Null>	<Null>	<Null>		7/13/2023
617 Point	CB1095	CITY	GHC2112	<Null>	<Null>	<Null>		7/13/2023
626 Point	CB1104	CITY	GHC2004	<Null>	<Null>	<Null>		7/13/2023
1037 Point	CB474	CITY	GHC2108	<Null>	<Null>	<Null>		7/13/2023
1490 Point	CB1504	CITY	GHC2108	<Null>	<Null>	<Null>		7/13/2023
1493 Point	CB1507	CITY	GHC2108	<Null>	<Null>	<Null>		7/13/2023
1496 Point	CB1510	CITY	GHC2108	<Null>	<Null>	<Null>		7/13/2023

1640 Point	CB1612	<Null>	<Null>	<Null>	<Null>	<Null>	7/13/2023
1641 Point	CB1613	<Null>	<Null>	<Null>	<Null>	<Null>	7/13/2023
1642 Point	CB1614	<Null>	<Null>	<Null>	<Null>	<Null>	7/13/2023
217 Point	CB220	CITY	GHC2112	<Null>	<Null>	<Null>	7/12/2023
167 Point	CB173	CITY	GHC2108	<Null>	<Null>	<Null>	7/10/2023
169 Point	CB175	CITY	GHC2108	<Null>	<Null>	<Null>	7/10/2023
170 Point	CB176	CITY	GHC2108	<Null>	<Null>	<Null>	7/10/2023
183 Point	CB186	CITY	GHC2111	<Null>	<Null>	<Null>	7/10/2023
507 Point	CB985	CITY	GHC2112	<Null>	<Null>	<Null>	7/10/2023
582 Point	CB1060	CITY	GHC2024	<Null>	<Null>	<Null>	7/10/2023
585 Point	CB1063	CITY	GHC2024	<Null>	<Null>	<Null>	7/10/2023
588 Point	CB1066	CITY	GHC2024	<Null>	<Null>	<Null>	7/10/2023
589 Point	CB1067	CITY	GHC2024	<Null>	<Null>	<Null>	7/10/2023
590 Point	CB1068	CITY	GHC2024	<Null>	<Null>	<Null>	7/10/2023
695 Point	CB1173	CITY	GHC2112	<Null>	<Null>	<Null>	7/10/2023
811 Point	CB1424	CITY	GHC2024	<Null>	<Null>	<Null>	7/10/2023
1036 Point	CB473	CITY	GHC2108	<Null>	<Null>	<Null>	7/10/2023
1038 Point	CB475	CITY	GHC2108	<Null>	<Null>	<Null>	7/10/2023
1398 Point	CB849	CITY	GHC2024	<Null>	<Null>	<Null>	7/10/2023
1460 Point	CB793	CITY	GHC2024	<Null>	<Null>	<Null>	7/10/2023
1461 Point	CB794	CITY	GHC2024	<Null>	<Null>	<Null>	7/10/2023
486 Point	CB963	CITY	GHC2024	<Null>	<Null>	<Null>	6/29/2023
487 Point	CB964	CITY	GHC2024	<Null>	<Null>	<Null>	6/29/2023
689 Point	CB1167	CITY	GHC2112	<Null>	<Null>	<Null>	6/29/2023
690 Point	CB1168	CITY	GHC2112	<Null>	<Null>	<Null>	6/29/2023
691 Point	CB1169	CITY	GHC2112	<Null>	<Null>	<Null>	6/29/2023
701 Point	CB1179	CITY	GHC2112	<Null>	<Null>	<Null>	6/29/2023
702 Point	CB1180	CITY	GHC2112	<Null>	<Null>	<Null>	6/29/2023
707 Point	CB1185	CITY	GHC2112	<Null>	<Null>	<Null>	6/29/2023
713 Point	CB1191	CITY	GHC2106	<Null>	<Null>	<Null>	6/29/2023
714 Point	CB1192	CITY	GHC2106	<Null>	<Null>	<Null>	6/29/2023
715 Point	CB1193	CITY	GHC2106	<Null>	<Null>	<Null>	6/29/2023
817 Point	CB1430	CITY	GHC2024	<Null>	<Null>	<Null>	6/29/2023
1211 Point	CB1223	CITY	GHC2106	<Null>	<Null>	<Null>	6/29/2023
1212 Point	CB1224	CITY	GHC2106	<Null>	<Null>	<Null>	6/29/2023
1213 Point	CB1225	CITY	GHC2106	<Null>	<Null>	<Null>	6/29/2023
1214 Point	CB1226	CITY	GHC2106	<Null>	<Null>	<Null>	6/29/2023
1215 Point	CB1227	CITY	GHC2106	<Null>	<Null>	<Null>	6/29/2023
1242 Point	CB1253	CITY	GHC2106	<Null>	<Null>	<Null>	6/29/2023
1243 Point	CB1254	CITY	GHC2106	<Null>	<Null>	<Null>	6/29/2023
1465 Point	CB798	CITY	GHC2024	<Null>	<Null>	<Null>	6/29/2023
1467 Point	CB800	CITY	GHC2024	<Null>	<Null>	<Null>	6/29/2023
1497 Point	CB1511	CITY	GHC2108	<Null>	<Null>	<Null>	6/29/2023
1498 Point	CB1512	CITY	GHC2108	<Null>	<Null>	<Null>	6/29/2023
1499 Point	CB1513	CITY	GHC2108	<Null>	<Null>	<Null>	6/29/2023
1500 Point	CB1514	CITY	GHC2108	<Null>	<Null>	<Null>	6/29/2023
1501 Point	CB1515	CITY	GHC2108	<Null>	<Null>	<Null>	6/29/2023

1523 Point	CB1538	<Null>	GHC2106	<Null>	<Null>	<Null>	6/29/2023
1558 Point	CB1576	<Null>	<Null>	<Null>	<Null>	<Null>	6/29/2023
1559 Point	CB1577	<Null>	<Null>	<Null>	<Null>	<Null>	6/29/2023
1651 Point	CB1621	CITY	GHC2106	New	<Null>	<Null>	6/29/2023
1653 Point	CB1626	CITY	GHC2106	New	<Null>	<Null>	6/29/2023
684 Point	CB1162	CITY	GHC2003	<Null>	<Null>	<Null>	6/28/2023
687 Point	CB1165	CITY	GHC2003	<Null>	<Null>	<Null>	6/28/2023
1491 Point	CB1505	CITY	GHC2108	<Null>	<Null>	<Null>	6/28/2023
1495 Point	CB1509	CITY	GHC2108	<Null>	<Null>	<Null>	6/28/2023
316 Point	CB370	CITY	GHC2108	<Null>	<Null>	<Null>	6/27/2023
317 Point	CB371	CITY	GHC2108	<Null>	<Null>	<Null>	6/27/2023
321 Point	CB375	CITY	GHC2108	<Null>	<Null>	<Null>	6/27/2023
493 Point	CB970	CITY	GHC2112	<Null>	<Null>	<Null>	6/27/2023
504 Point	CB982	CITY	GHC2112	<Null>	<Null>	<Null>	6/27/2023
506 Point	CB984	CITY	GHC2112	<Null>	<Null>	<Null>	6/27/2023
516 Point	CB994	CITY	GHC2112	<Null>	<Null>	<Null>	6/27/2023
517 Point	CB995	CITY	GHC2112	<Null>	<Null>	<Null>	6/27/2023
1025 Point	CB462	CITY	GHC2108	<Null>	<Null>	<Null>	6/27/2023
1269 Point	CB1280	CITY	GHC2112	<Null>	<Null>	<Null>	6/27/2023
1386 Point	CB837	CITY	GHC2112	<Null>	<Null>	<Null>	6/27/2023
1387 Point	CB838	CITY	GHC2112	<Null>	<Null>	<Null>	6/27/2023
1388 Point	CB839	CITY	GHC2112	<Null>	<Null>	<Null>	6/27/2023
1389 Point	CB840	CITY	GHC2112	<Null>	<Null>	<Null>	6/27/2023
1390 Point	CB841	CITY	GHC2112	<Null>	<Null>	<Null>	6/27/2023
1392 Point	CB843	CITY	GHC2112	<Null>	<Null>	<Null>	6/27/2023
1393 Point	CB844	CITY	GHC2112	<Null>	<Null>	<Null>	6/27/2023
1470 Point	CB803	CITY	GHC2112	<Null>	<Null>	<Null>	6/27/2023
1474 Point	CB807	CITY	GHC2112	<Null>	<Null>	<Null>	6/27/2023
374 Point	CB668	CITY	GHC2804	<Null>	<Null>	<Null>	6/26/2023
51 Point	CB55	CITY	GHC2804	<Null>	<Null>	<Null>	6/21/2023
325 Point	CB379	CITY	GHC2108	<Null>	<Null>	<Null>	6/21/2023
326 Point	CB380	CITY	GHC2108	<Null>	<Null>	<Null>	6/21/2023
494 Point	CB971	CITY	GHC2112	<Null>	<Null>	<Null>	6/21/2023
495 Point	CB972	CITY	GHC2112	<Null>	<Null>	<Null>	6/21/2023
499 Point	CB976	CITY	GHC2112	<Null>	Failing	<Null>	6/21/2023
500 Point	CB978	CITY	GHC2112	<Null>	<Null>	<Null>	6/21/2023
501 Point	CB979	CITY	GHC2112	<Null>	<Null>	<Null>	6/21/2023
530 Point	CB1447	CITY	GHC2112	<Null>	<Null>	<Null>	6/21/2023
1319 Point	CB745	CITY	GHC2112	<Null>	<Null>	<Null>	6/21/2023
1394 Point	CB845	CITY	GHC2112	<Null>	<Null>	<Null>	6/21/2023
1395 Point	CB846	CITY	GHC2112	<Null>	<Null>	<Null>	6/21/2023
1396 Point	CB847	CITY	GHC2112	<Null>	<Null>	<Null>	6/21/2023
1456 Point	CB789	CITY	GHC2024	<Null>	<Null>	<Null>	6/21/2023
1459 Point	CB792	CITY	GHC2024	<Null>	<Null>	<Null>	6/21/2023
1471 Point	CB804	CITY	GHC2112	<Null>	<Null>	<Null>	6/21/2023
1473 Point	CB806	CITY	GHC2112	<Null>	<Null>	<Null>	6/21/2023
106 Point	CB59	CITY	GHC2804	<Null>	<Null>	<Null>	6/20/2023

354 Point	CB648	CITY	GHC2804	<Null>	<Null>	<Null>	6/20/2023
381 Point	CB779	CITY	GHC2804	<Null>	<Null>	<Null>	6/20/2023
796 Point	CB1409	CITY	GHC2804	<Null>	<Null>	<Null>	6/20/2023
1176 Point	CB774	CITY	GHC2804	<Null>	<Null>	<Null>	6/20/2023
1177 Point	CB775	CITY	GHC2804	<Null>	<Null>	<Null>	6/20/2023
1344 Point	CB770	CITY	GHC2804	<Null>	<Null>	<Null>	6/20/2023
1345 Point	CB771	CITY	GHC2804	<Null>	<Null>	<Null>	6/20/2023
1347 Point	CB773	CITY	GHC2804	<Null>	<Null>	<Null>	6/20/2023
1447 Point	CB780	CITY	GHC2804	<Null>	<Null>	<Null>	6/20/2023
1448 Point	CB781	CITY	GHC2804	<Null>	<Null>	<Null>	6/20/2023
1449 Point	CB782	CITY	GHC2804	<Null>	<Null>	<Null>	6/20/2023
1451 Point	CB784	CITY	GHC2804	<Null>	<Null>	<Null>	6/20/2023
172 Point	CB178	CITY	GHC2108	<Null>	<Null>	<Null>	6/19/2023
219 Point	CB223	CITY	GHC2108	Broken	<Null>	<Null>	6/19/2023
602 Point	CB1080	CITY	GHC2024	Good	Good	<Null>	6/19/2023
603 Point	CB1081	CITY	GHC2024	Good	Good	<Null>	6/19/2023
1139 Point	CB573	CITY	GHC2108	<Null>	<Null>	<Null>	6/19/2023
1536 Point	CB1554	<Null>	<Null>	Good	Good	<Null>	6/19/2023
1537 Point	CB1555	<Null>	<Null>	Good	Good	<Null>	6/19/2023
1538 Point	CB1556	<Null>	<Null>	Good	Good	<Null>	6/19/2023
1542 Point	CB1560	<Null>	<Null>	Good	Good	<Null>	6/19/2023
1543 Point	CB1561	<Null>	<Null>	Good	Good	<Null>	6/19/2023
1544 Point	CB1562	<Null>	<Null>	Good	Good	<Null>	6/19/2023
1545 Point	CB1563	<Null>	<Null>	<Null>	<Null>	<Null>	6/19/2023
1550 Point	CB1568	City	<Null>	Good	<Null>	<Null>	6/19/2023
1552 Point	CB1571	City	<Null>	Good	<Null>	<Null>	6/19/2023
1554 Point	CB1572	City	<Null>	Good	<Null>	<Null>	6/19/2023
1557 Point	CB1575	City	<Null>	Good	<Null>	<Null>	6/19/2023
1601 Point	<Null>	<Null>	<Null>	Good	Good	<Null>	6/19/2023
1788 Point	<Null>	<Null>	<Null>	<Null>	<Null>	<Null>	6/19/2023
671 Point	CB1149	CITY	GHC2003	Good	<Null>	<Null>	6/16/2023
575 Point	CB1053	CITY	GHC2905	<Null>	<Null>	<Null>	6/15/2023
576 Point	CB1054	CITY	GHC2905	<Null>	<Null>	<Null>	6/15/2023
1531 Point	CB1549	<Null>	<Null>	Good	Good	<Null>	6/15/2023
1532 Point	CB1550	<Null>	<Null>	Good	Good	<Null>	6/15/2023
1533 Point	CB1551	<Null>	<Null>	Good	Good	<Null>	6/15/2023
1534 Point	CB1552	<Null>	<Null>	Good	Good	<Null>	6/15/2023
1541 Point	CB1559	<Null>	<Null>	Good	Good	<Null>	6/15/2023
1546 Point	CB1564	<Null>	<Null>	Good	Good	<Null>	6/15/2023
1551 Point	CB1569	City	<Null>	Good	<Null>	<Null>	6/15/2023
1553 Point	CB1570	City	<Null>	Good	<Null>	<Null>	6/15/2023
1555 Point	CB1573	City	<Null>	Good	<Null>	<Null>	6/15/2023
1556 Point	CB1574	City	<Null>	Good	<Null>	<Null>	6/15/2023
1598 Point	<Null>	<Null>	<Null>	<Null>	<Null>	<Null>	6/15/2023
1602 Point	<Null>	<Null>	<Null>	Good	Good	<Null>	6/15/2023
1750 Point	<Null>	<Null>	<Null>	Good	Good	<Null>	6/15/2023
405 Point	CB698	CITY	GHC2112	<Null>	<Null>	<Null>	6/14/2023

406 Point	CB699	CITY	GHC2112	<Null>	<Null>	<Null>	6/14/2023
407 Point	CB700	CITY	GHC2112	<Null>	<Null>	<Null>	6/14/2023
408 Point	CB701	CITY	GHC2112	<Null>	<Null>	<Null>	6/14/2023
515 Point	CB993	CITY	GHC2112	Good	<Null>	<Null>	6/14/2023
519 Point	CB997	CITY	GHC2112	Good	<Null>	<Null>	6/14/2023
520 Point	CB998	CITY	GHC2112	Good	<Null>	<Null>	6/14/2023
620 Point	CB1098	CITY	GHC2024	<Null>	<Null>	<Null>	6/14/2023
658 Point	CB1136	CITY	GHC2004	Good	<Null>	<Null>	6/14/2023
659 Point	CB1137	CITY	GHC2004	<Null>	<Null>	<Null>	6/14/2023
688 Point	CB1166	CITY	GHC2112	<Null>	<Null>	<Null>	6/14/2023
703 Point	CB1181	CITY	GHC2112	<Null>	<Null>	<Null>	6/14/2023
851 Point	CB1465	CITY	GHC2003	Good	Good	<Null>	6/14/2023
860 Point	CB1477	CITY	GHC2003	Good	Good	<Null>	6/14/2023
862 Point	CB1479	CITY	GHC2106	Good	<Null>	<Null>	6/14/2023
863 Point	CB1480	CITY	GHC2106	Good	<Null>	<Null>	6/14/2023
864 Point	CB1481	CITY	GHC2106	Good	Good	<Null>	6/14/2023
865 Point	CB1482	CITY	GHC2106	Good	<Null>	<Null>	6/14/2023
866 Point	CB1483	CITY	GHC2106	Good	<Null>	<Null>	6/14/2023
1046 Point	CB1467	CITY	GHC2112	Good	<Null>	<Null>	6/14/2023
1047 Point	CB1468	CITY	GHC2112	<Null>	<Null>	<Null>	6/14/2023
1261 Point	CB1272	CITY	GHC2112	Good	<Null>	<Null>	6/14/2023
1294 Point	CB1307	CITY	GHC2003	Good	Good	<Null>	6/14/2023
1295 Point	CB1308	CITY	GHC2003	Good	Good	<Null>	6/14/2023
1296 Point	CB1309	CITY	GHC2003	Good	Good	<Null>	6/14/2023
1297 Point	CB1310	CITY	GHC2003	Good	<Null>	<Null>	6/14/2023
1303 Point	CB1316	CITY	GHC2025	Good	<Null>	<Null>	6/14/2023
1304 Point	CB1317	CITY	GHC2025	Good	<Null>	<Null>	6/14/2023
1527 Point	CB1545	<Null>	<Null>	Good	<Null>	<Null>	6/14/2023
1529 Point	CB1547	City	<Null>	Good	Good	<Null>	6/14/2023
1530 Point	CB1548	City	<Null>	Good	Good	<Null>	6/14/2023
1596 Point	<Null>	<Null>	<Null>	<Null>	<Null>	<Null>	6/14/2023
1597 Point	<Null>	<Null>	<Null>	<Null>	<Null>	<Null>	6/14/2023
1599 Point	<Null>	<Null>	<Null>	<Null>	<Null>	<Null>	6/14/2023
1600 Point	<Null>	<Null>	<Null>	<Null>	<Null>	<Null>	6/14/2023
1131 Point	CB565	CITY	GHC2112	<Null>	<Null>	<Null>	6/13/2023
1835 Point	<Null>	<Null>	<Null>	<Null>	<Null>	<Null>	6/13/2023
1836 Point	<Null>	<Null>	<Null>	<Null>	<Null>	<Null>	6/13/2023
210 Point	CB213	CITY	GHC2108	<Null>	Leaking or	<Null>	6/12/2023
211 Point	CB214	CITY	GHC2108	<Null>	Leaking or	<Null>	6/12/2023
213 Point	CB216	CITY	GHC2108	<Null>	<Null>	<Null>	6/12/2023
216 Point	CB219	CITY	GHC2108	<Null>	<Null>	<Null>	6/12/2023
339 Point	CB633	CITY	GHC2804	<Null>	<Null>	<Null>	6/12/2023
340 Point	CB634	CITY	GHC2804	<Null>	<Null>	<Null>	6/12/2023
341 Point	CB635	CITY	GHC2804	<Null>	<Null>	<Null>	6/12/2023
342 Point	CB636	CITY	GHC2804	<Null>	<Null>	<Null>	6/12/2023
345 Point	CB639	CITY	GHC2804	<Null>	<Null>	<Null>	6/12/2023
348 Point	CB642	CITY	GHC2804	<Null>	<Null>	<Null>	6/12/2023

350 Point	CB644	CITY	GHC2804	<Null>	<Null>	<Null>	6/12/2023
352 Point	CB646	CITY	GHC2804	<Null>	<Null>	<Null>	6/12/2023
366 Point	CB660	CITY	GHC2804	<Null>	<Null>	<Null>	6/12/2023
368 Point	CB662	CITY	GHC2804	<Null>	<Null>	<Null>	6/12/2023
373 Point	CB667	CITY	GHC2804	<Null>	<Null>	<Null>	6/12/2023
375 Point	CB669	CITY	GHC2804	<Null>	<Null>	<Null>	6/12/2023
377 Point	CB671	CITY	GHC2804	<Null>	<Null>	<Null>	6/12/2023
793 Point	CB1406	CITY	GHC2804	<Null>	<Null>	<Null>	6/12/2023
794 Point	CB1407	CITY	GHC2804	<Null>	<Null>	<Null>	6/12/2023
795 Point	CB1408	CITY	GHC2804	<Null>	<Null>	<Null>	6/12/2023
891 Point	CB617	CITY	GHC2804	<Null>	<Null>	<Null>	6/12/2023
1183 Point	CB625	CITY	GHC2804	<Null>	<Null>	<Null>	6/12/2023
1186 Point	CB628	CITY	GHC2804	<Null>	<Null>	<Null>	6/12/2023
205 Point	CB208	CITY	GHC2111	<Null>	<Null>	<Null>	6/6/2023
295 Point	CB349	CITY	GHC2804	<Null>	<Null>	<Null>	6/6/2023
301 Point	CB355	CITY	GHC2804	<Null>	<Null>	<Null>	6/6/2023
307 Point	CB361	CITY	GHC2804	<Null>	<Null>	<Null>	6/6/2023
312 Point	CB366	CITY	GHC2801	<Null>	<Null>	<Null>	6/6/2023
323 Point	CB377	CITY	GHC2108	<Null>	<Null>	<Null>	6/6/2023
329 Point	CB383	CITY	GHC2108	<Null>	<Null>	<Null>	6/6/2023
332 Point	CB386	CITY	GHC2108	<Null>	<Null>	<Null>	6/6/2023
333 Point	CB387	CITY	GHC2108	<Null>	<Null>	<Null>	6/6/2023
525 Point	CB1049	CITY	GHC2801	<Null>	<Null>	<Null>	6/6/2023
954 Point	CB390	CITY	GHC2108	<Null>	<Null>	<Null>	6/6/2023
955 Point	CB391	CITY	GHC2108	<Null>	<Null>	<Null>	6/6/2023
959 Point	CB395	CITY	GHC2108	<Null>	<Null>	<Null>	6/6/2023
962 Point	CB398	CITY	GHC2108	<Null>	<Null>	<Null>	6/6/2023
963 Point	CB399	CITY	GHC2108	<Null>	<Null>	<Null>	6/6/2023
965 Point	CB401	CITY	GHC2108	<Null>	<Null>	<Null>	6/6/2023
969 Point	CB405	CITY	GHC2801	<Null>	<Null>	<Null>	6/6/2023
970 Point	CB406	CITY	GHC2801	<Null>	<Null>	<Null>	6/6/2023
1004 Point	CB441	CITY	GHC2108	<Null>	<Null>	<Null>	6/6/2023
1023 Point	CB460	CITY	GHC2108	<Null>	<Null>	<Null>	6/6/2023
1024 Point	CB461	CITY	GHC2108	<Null>	<Null>	<Null>	6/6/2023
184 Point	CB187	CITY	GHC2111	<Null>	<Null>	<Null>	6/5/2023
185 Point	CB188	CITY	GHC2111	<Null>	<Null>	<Null>	6/5/2023
248 Point	CB252	CITY	GHC2801	<Null>	<Null>	<Null>	6/5/2023
250 Point	CB254	CITY	GHC2801	<Null>	<Null>	<Null>	6/5/2023
251 Point	CB255	CITY	GHC2801	<Null>	<Null>	<Null>	6/5/2023
261 Point	CB263	CITY	GHC2210	<Null>	<Null>	<Null>	6/5/2023
279 Point	CB281	CITY	GHC2801	<Null>	<Null>	<Null>	6/5/2023
288 Point	CB342	CITY	GHC2111	<Null>	<Null>	<Null>	6/5/2023
290 Point	CB344	CITY	GHC2111	<Null>	<Null>	<Null>	6/5/2023
291 Point	CB345	CITY	GHC2111	<Null>	<Null>	<Null>	6/5/2023
292 Point	CB346	CITY	GHC2111	<Null>	<Null>	<Null>	6/5/2023
748 Point	CB1357	CITY	GHC2210	<Null>	<Null>	<Null>	6/5/2023
763 Point	CB1374	CITY	GHC2111	<Null>	<Null>	<Null>	6/5/2023

906 Point	CB290	CITY	GHC2210	<Null>	<Null>	<Null>	6/5/2023
907 Point	CB291	CITY	GHC2210	<Null>	<Null>	<Null>	6/5/2023
908 Point	CB292	CITY	GHC2210	<Null>	<Null>	<Null>	6/5/2023
914 Point	CB298	CITY	GHC2210	<Null>	<Null>	<Null>	6/5/2023
925 Point	CB309	CITY	GHC2210	<Null>	<Null>	<Null>	6/5/2023
926 Point	CB310	CITY	GHC2210	<Null>	<Null>	<Null>	6/5/2023
932 Point	CB316	CITY	GHC2210	<Null>	<Null>	<Null>	6/5/2023
933 Point	CB317	CITY	GHC2210	<Null>	<Null>	<Null>	6/5/2023
934 Point	CB318	CITY	GHC2210	<Null>	<Null>	<Null>	6/5/2023
1028 Point	CB465	CITY	GHC2111	<Null>	<Null>	<Null>	6/5/2023
225 Point	CB229	CITY	GHC2804	<Null>	<Null>	<Null>	6/1/2023
241 Point	CB245	CITY	GHC2801	<Null>	<Null>	<Null>	6/1/2023
247 Point	CB251	CITY	GHC2801	<Null>	<Null>	<Null>	6/1/2023
252 Point	CB256	CITY	GHC2801	<Null>	<Null>	<Null>	6/1/2023
260 Point	CB262	CITY	GHC2801	<Null>	<Null>	<Null>	6/1/2023
262 Point	CB264	CITY	GHC2210	<Null>	<Null>	<Null>	6/1/2023
269 Point	CB271	CITY	GHC2210	<Null>	<Null>	<Null>	6/1/2023
270 Point	CB272	CITY	GHC2210	<Null>	<Null>	<Null>	6/1/2023
271 Point	CB273	CITY	GHC2210	<Null>	<Null>	<Null>	6/1/2023
294 Point	CB348	CITY	GHC2804	<Null>	<Null>	<Null>	6/1/2023
847 Point	CB1461	CITY	GHC2210	<Null>	<Null>	<Null>	6/1/2023
848 Point	CB1462	CITY	GHC2210	<Null>	<Null>	<Null>	6/1/2023
852 Point	CB1466	CITY	GHC2804	<Null>	<Null>	<Null>	6/1/2023
1338 Point	CB764	CITY	GHC2804	<Null>	<Null>	<Null>	6/1/2023
1340 Point	CB766	CITY	GHC2804	<Null>	<Null>	<Null>	6/1/2023
1374 Point	CB825	CITY	GHC2804	<Null>	<Null>	<Null>	6/1/2023
1375 Point	CB826	CITY	GHC2804	<Null>	<Null>	<Null>	6/1/2023
179 Point	CB1543	<Null>	<Null>	<Null>	<Null>	<Null>	5/31/2023
180 Point	CB183	CITY	GHC2111	<Null>	<Null>	<Null>	5/31/2023
181 Point	CB184	CITY	GHC2111	<Null>	<Null>	<Null>	5/31/2023
977 Point	CB413	CITY	GHC2801	<Null>	<Null>	<Null>	5/31/2023
979 Point	CB415	CITY	GHC2801	<Null>	<Null>	<Null>	5/31/2023
980 Point	CB416	CITY	GHC2801	<Null>	<Null>	<Null>	5/31/2023
985 Point	CB421	CITY	GHC2210	<Null>	<Null>	<Null>	5/31/2023
986 Point	CB422	CITY	GHC2210	<Null>	<Null>	<Null>	5/31/2023
989 Point	CB425	CITY	GHC2210	<Null>	<Null>	<Null>	5/31/2023
994 Point	CB430	CITY	GHC2210	<Null>	<Null>	<Null>	5/31/2023
995 Point	CB431	CITY	GHC2210	<Null>	<Null>	<Null>	5/31/2023
996 Point	CB432	CITY	GHC2210	<Null>	<Null>	<Null>	5/31/2023
997 Point	CB433	CITY	GHC2210	<Null>	<Null>	<Null>	5/31/2023
1000 Point	CB437	CITY	GHC2210	<Null>	<Null>	<Null>	5/31/2023
1001 Point	CB438	CITY	GHC2210	<Null>	<Null>	<Null>	5/31/2023
1003 Point	CB440	CITY	GHC2210	<Null>	<Null>	<Null>	5/31/2023
1008 Point	CB445	CITY	GHC2210	<Null>	<Null>	<Null>	5/31/2023
1009 Point	CB446	CITY	GHC2210	<Null>	<Null>	<Null>	5/31/2023
1017 Point	CB454	CITY	GHC2210	<Null>	<Null>	<Null>	5/31/2023
1018 Point	CB455	CITY	GHC2210	<Null>	<Null>	<Null>	5/31/2023

1019 Point	CB456	CITY	GHC2210	<Null>	<Null>	<Null>	5/31/2023
1020 Point	CB457	CITY	GHC2210	<Null>	<Null>	<Null>	5/31/2023
1021 Point	CB458	CITY	GHC2210	<Null>	<Null>	<Null>	5/31/2023
1029 Point	CB466	CITY	GHC2111	<Null>	<Null>	<Null>	5/30/2023
1030 Point	CB467	CITY	GHC2111	<Null>	<Null>	<Null>	5/30/2023
1032 Point	CB469	CITY	GHC2111	<Null>	<Null>	<Null>	5/30/2023
1033 Point	CB470	CITY	GHC2111	<Null>	<Null>	<Null>	5/30/2023
1035 Point	CB472	CITY	GHC2111	<Null>	<Null>	<Null>	5/30/2023
1044 Point	CB480	CITY	GHC2804	<Null>	<Null>	<Null>	5/30/2023
1045 Point	CB481	CITY	GHC2804	<Null>	<Null>	<Null>	5/30/2023
1048 Point	CB482	CITY	GHC2804	<Null>	<Null>	<Null>	5/30/2023
1049 Point	CB483	CITY	GHC2804	<Null>	<Null>	<Null>	5/30/2023
1050 Point	CB484	CITY	GHC2804	<Null>	<Null>	<Null>	5/30/2023
1051 Point	CB485	CITY	GHC2804	<Null>	<Null>	<Null>	5/30/2023
173 Point	CB179	CITY	GHC2108	<Null>	<Null>	<Null>	5/16/2023
770 Point	CB1381	CITY	GHC2108	<Null>	<Null>	<Null>	5/16/2023
772 Point	CB1383	CITY	GHC2108	<Null>	<Null>	<Null>	5/16/2023
1075 Point	CB509	CITY	GHC2801	<Null>	<Null>	<Null>	5/16/2023
1076 Point	CB510	CITY	GHC2801	<Null>	<Null>	<Null>	5/16/2023
1100 Point	CB534	CITY	GHC2108	<Null>	<Null>	<Null>	5/16/2023
1101 Point	CB535	CITY	GHC2108	<Null>	<Null>	<Null>	5/16/2023
1103 Point	CB537	CITY	GHC2108	<Null>	<Null>	<Null>	5/16/2023
1113 Point	CB547	CITY	GHC2108	<Null>	<Null>	<Null>	5/16/2023
1114 Point	CB548	CITY	GHC2108	<Null>	<Null>	<Null>	5/16/2023
1116 Point	CB550	CITY	GHC2108	<Null>	<Null>	<Null>	5/16/2023
1121 Point	CB555	CITY	GHC2108	<Null>	<Null>	<Null>	5/16/2023
1124 Point	CB558	CITY	GHC2108	<Null>	<Null>	<Null>	5/16/2023
1125 Point	CB559	CITY	GHC2108	<Null>	<Null>	<Null>	5/16/2023
1128 Point	CB562	CITY	GHC2108	<Null>	<Null>	<Null>	5/15/2023
1129 Point	CB563	CITY	GHC2108	<Null>	<Null>	<Null>	5/15/2023
1379 Point	CB830	CITY	GHC2804	<Null>	<Null>	<Null>	5/15/2023
1380 Point	CB831	CITY	GHC2804	<Null>	<Null>	<Null>	5/15/2023
1453 Point	CB786	CITY	GHC2804	<Null>	<Null>	<Null>	5/15/2023
212 Point	CB215	CITY	GHC2108	<Null>	<Null>	<Null>	5/10/2023
716 Point	CB1194	CITY	GHC2106	<Null>	<Null>	<Null>	5/10/2023
836 Point	CB1450	CITY	GHC2112	<Null>	<Null>	<Null>	5/10/2023
1005 Point	CB442	CITY	GHC2108	<Null>	<Null>	<Null>	5/10/2023
1084 Point	CB518	CITY	GHC2112	<Null>	<Null>	<Null>	5/10/2023
1216 Point	CB1228	CITY	GHC2106	<Null>	<Null>	<Null>	5/10/2023
1217 Point	CB1229	CITY	GHC2106	<Null>	<Null>	<Null>	5/10/2023
1218 Point	CB1230	CITY	GHC2106	<Null>	<Null>	<Null>	5/10/2023
1219 Point	CB1231	CITY	GHC2106	<Null>	<Null>	<Null>	5/10/2023
1222 Point	CB1235	CITY	GHC2112	<Null>	<Null>	<Null>	5/10/2023
1280 Point	CB1291	CITY	GHC2112	<Null>	<Null>	<Null>	5/10/2023
1381 Point	CB832	CITY	GHC2804	<Null>	<Null>	<Null>	5/10/2023
1382 Point	CB833	CITY	GHC2804	<Null>	<Null>	<Null>	5/10/2023
1383 Point	CB834	CITY	GHC2804	<Null>	<Null>	<Null>	5/10/2023

1450 Point	CB783	CITY	GHC2804	<Null>	<Null>	<Null>	5/10/2023
1452 Point	CB785	CITY	GHC2804	<Null>	<Null>	<Null>	5/10/2023
1455 Point	CB788	CITY	GHC2804	<Null>	<Null>	<Null>	5/10/2023
1457 Point	CB790	CITY	GHC2024	<Null>	<Null>	<Null>	5/10/2023
1458 Point	CB791	CITY	GHC2024	<Null>	<Null>	<Null>	5/10/2023
1475 Point	CB808	CITY	GHC2112	<Null>	<Null>	<Null>	5/10/2023
1476 Point	CB809	CITY	GHC2112	<Null>	<Null>	<Null>	5/10/2023
1477 Point	CB810	CITY	GHC2112	<Null>	<Null>	<Null>	5/10/2023
1656 Point	CB1634	CITY	GHC2106	New	<Null>	<Null>	5/10/2023
1665 Point	CB1641	CITY	GHC2112	New	<Null>	<Null>	5/10/2023
1666 Point	CB1637	CITY	GHC2112	New	<Null>	<Null>	5/10/2023
1668 Point	CB1639	CITY	GHC2112	New	<Null>	<Null>	5/10/2023
1366 Point	CB818	CITY	GHC2112	<Null>	<Null>	<Null>	5/2/2023
1367 Point	CB819	CITY	GHC2804	<Null>	<Null>	<Null>	5/2/2023
1368 Point	CB820	CITY	GHC2804	<Null>	<Null>	<Null>	5/2/2023
1370 Point	CB821	CITY	GHC2804	<Null>	<Null>	<Null>	5/2/2023
1371 Point	CB822	CITY	GHC2804	<Null>	<Null>	<Null>	5/2/2023
1484 Point	CB817	CITY	GHC2112	<Null>	<Null>	<Null>	5/2/2023
103 Point	CB56	CITY	GHC2804	<Null>	<Null>	<Null>	4/27/2023
104 Point	CB57	CITY	GHC2804	<Null>	<Null>	<Null>	4/27/2023
105 Point	CB58	CITY	GHC2804	<Null>	<Null>	<Null>	4/27/2023
107 Point	CB60	CITY	GHC2804	<Null>	<Null>	<Null>	4/27/2023
108 Point	CB61	CITY	GHC2804	<Null>	<Null>	<Null>	4/27/2023
109 Point	CB62	CITY	GHC2804	<Null>	<Null>	<Null>	4/27/2023
110 Point	CB63	CITY	GHC2804	<Null>	<Null>	<Null>	4/27/2023
111 Point	CB64	CITY	GHC2804	<Null>	<Null>	<Null>	4/27/2023
112 Point	CB65	CITY	GHC2804	<Null>	<Null>	<Null>	4/27/2023
556 Point	CB1034	CITY	GHC2804	<Null>	<Null>	<Null>	4/27/2023
802 Point	CB1415	CITY	GHC2804	<Null>	<Null>	<Null>	4/27/2023
296 Point	CB350	CITY	GHC2804	<Null>	<Null>	<Null>	4/25/2023
327 Point	CB381	CITY	GHC2108	<Null>	<Null>	<Null>	4/25/2023
966 Point	CB402	CITY	GHC2801	<Null>	<Null>	<Null>	4/25/2023
974 Point	CB410	CITY	GHC2801	<Null>	<Null>	<Null>	4/25/2023
975 Point	CB411	CITY	GHC2801	<Null>	<Null>	<Null>	4/25/2023
976 Point	CB412	CITY	GHC2801	<Null>	<Null>	<Null>	4/25/2023
113 Point	CB66	CITY	GHC2804	<Null>	<Null>	<Null>	4/24/2023
114 Point	CB67	CITY	GHC2804	<Null>	<Null>	<Null>	4/24/2023
543 Point	CB1021	CITY	GHC2804	<Null>	<Null>	<Null>	4/24/2023
799 Point	CB1412	CITY	GHC2804	<Null>	<Null>	<Null>	4/24/2023
800 Point	CB1413	CITY	GHC2804	<Null>	<Null>	<Null>	4/24/2023
801 Point	CB1414	CITY	GHC2804	<Null>	<Null>	<Null>	4/24/2023
223 Point	CB227	CITY	GHC2804	<Null>	<Null>	<Null>	4/6/2023
224 Point	CB228	CITY	GHC2804	<Null>	<Null>	<Null>	4/6/2023
233 Point	CB237	CITY	GHC2804	<Null>	<Null>	<Null>	4/6/2023
234 Point	CB238	CITY	GHC2804	<Null>	<Null>	<Null>	4/6/2023
235 Point	CB239	CITY	GHC2804	<Null>	<Null>	<Null>	4/6/2023
236 Point	CB240	CITY	GHC2804	<Null>	<Null>	<Null>	4/6/2023

268 Point	CB270	CITY	GHC2210	<Null>	<Null>	<Null>	4/3/2023
280 Point	CB282	CITY	GHC2801	<Null>	<Null>	<Null>	4/3/2023
311 Point	CB365	CITY	GHC2801	<Null>	<Null>	<Null>	4/3/2023
313 Point	CB367	CITY	GHC2801	<Null>	<Null>	<Null>	4/3/2023
314 Point	CB368	CITY	GHC2801	<Null>	<Null>	<Null>	4/3/2023
319 Point	CB373	CITY	GHC2108	<Null>	<Null>	<Null>	4/3/2023
797 Point	CB1410	CITY	GHC2804	<Null>	<Null>	<Null>	4/3/2023
798 Point	CB1411	CITY	GHC2804	<Null>	<Null>	<Null>	4/3/2023
967 Point	CB403	CITY	GHC2801	<Null>	<Null>	<Null>	4/3/2023
968 Point	CB404	CITY	GHC2801	<Null>	<Null>	<Null>	4/3/2023
971 Point	CB407	CITY	GHC2801	<Null>	<Null>	<Null>	4/3/2023
972 Point	CB408	CITY	GHC2801	<Null>	<Null>	<Null>	4/3/2023
973 Point	CB409	CITY	GHC2801	<Null>	<Null>	<Null>	4/3/2023
978 Point	CB414	CITY	GHC2801	<Null>	<Null>	<Null>	4/3/2023
1039 Point	CB476	CITY	GHC2108	<Null>	<Null>	<Null>	4/3/2023
1072 Point	CB506	CITY	GHC2801	<Null>	<Null>	<Null>	4/3/2023
1073 Point	CB507	CITY	GHC2801	<Null>	<Null>	<Null>	4/3/2023
1074 Point	CB508	CITY	GHC2801	<Null>	<Null>	<Null>	4/3/2023
1077 Point	CB511	CITY	GHC2801	<Null>	<Null>	<Null>	4/3/2023
1085 Point	CB519	CITY	GHC2112	<Null>	<Null>	<Null>	4/3/2023
1091 Point	CB525	CITY	GHC2804	<Null>	<Null>	<Null>	4/3/2023
1092 Point	CB526	CITY	GHC2804	<Null>	<Null>	<Null>	4/3/2023
1094 Point	CB528	CITY	GHC2801	<Null>	<Null>	<Null>	4/3/2023
1095 Point	CB529	CITY	GHC2801	<Null>	<Null>	<Null>	4/3/2023
1096 Point	CB530	CITY	GHC2801	<Null>	<Null>	<Null>	4/3/2023
1097 Point	CB531	CITY	GHC2801	<Null>	<Null>	<Null>	4/3/2023
1107 Point	CB541	CITY	GHC2108	<Null>	<Null>	<Null>	4/3/2023
1115 Point	CB549	CITY	GHC2108	<Null>	<Null>	<Null>	4/3/2023
1327 Point	CB753	CITY	GHC2804	<Null>	<Null>	<Null>	4/3/2023
1331 Point	CB757	CITY	GHC2804	<Null>	<Null>	<Null>	4/3/2023
1332 Point	CB758	CITY	GHC2804	<Null>	<Null>	<Null>	4/3/2023
1333 Point	CB759	CITY	GHC2804	<Null>	<Null>	<Null>	4/3/2023
1334 Point	CB760	CITY	GHC2804	<Null>	<Null>	<Null>	4/3/2023
1335 Point	CB761	CITY	GHC2804	<Null>	<Null>	<Null>	4/3/2023
1336 Point	CB762	CITY	GHC2804	<Null>	<Null>	<Null>	4/3/2023
1337 Point	CB763	CITY	GHC2804	<Null>	<Null>	<Null>	4/3/2023
1342 Point	CB768	CITY	GHC2804	<Null>	<Null>	<Null>	4/3/2023
1343 Point	CB769	CITY	GHC2804	<Null>	<Null>	<Null>	4/3/2023
1376 Point	CB827	CITY	GHC2804	<Null>	<Null>	<Null>	4/3/2023
1377 Point	CB828	CITY	GHC2804	<Null>	<Null>	<Null>	4/3/2023
1378 Point	CB829	CITY	GHC2804	<Null>	<Null>	<Null>	4/3/2023
1391 Point	CB842	CITY	GHC2112	<Null>	<Null>	<Null>	4/3/2023
1507 Point	CB1521	CITY	GHC2804	<Null>	<Null>	<Null>	4/3/2023
263 Point	CB265	CITY	GHC2210	<Null>	<Null>	<Null>	3/30/2023
264 Point	CB266	CITY	GHC2210	<Null>	<Null>	<Null>	3/30/2023
265 Point	CB267	CITY	GHC2210	<Null>	<Null>	<Null>	3/30/2023
266 Point	CB268	CITY	GHC2210	<Null>	<Null>	<Null>	3/30/2023

272 Point	CB274	CITY	GHC2715	<Null>	<Null>	<Null>	3/30/2023
328 Point	CB382	CITY	GHC2108	<Null>	<Null>	<Null>	3/30/2023
330 Point	CB384	CITY	GHC2108	<Null>	<Null>	<Null>	3/30/2023
331 Point	CB385	CITY	GHC2108	<Null>	<Null>	<Null>	3/30/2023
334 Point	CB388	CITY	GHC2108	<Null>	<Null>	<Null>	3/30/2023
335 Point	CB389	CITY	GHC2108	<Null>	<Null>	<Null>	3/30/2023
745 Point	CB1354	CITY	GHC2210	<Null>	<Null>	<Null>	3/30/2023
746 Point	CB1355	CITY	GHC2210	<Null>	<Null>	<Null>	3/30/2023
773 Point	CB1384	CITY	GHC2108	<Null>	<Null>	<Null>	3/30/2023
834 Point	CB1448	CITY	GHC2112	<Null>	<Null>	<Null>	3/30/2023
835 Point	CB1449	CITY	GHC2112	<Null>	<Null>	<Null>	3/30/2023
909 Point	CB293	CITY	GHC2210	<Null>	<Null>	<Null>	3/30/2023
910 Point	CB294	CITY	GHC2210	<Null>	<Null>	<Null>	3/30/2023
911 Point	CB295	CITY	GHC2210	<Null>	<Null>	<Null>	3/30/2023
912 Point	CB296	CITY	GHC2210	<Null>	<Null>	<Null>	3/30/2023
913 Point	CB297	CITY	GHC2210	<Null>	<Null>	<Null>	3/30/2023
915 Point	CB299	CITY	GHC2210	<Null>	<Null>	<Null>	3/30/2023
928 Point	CB312	CITY	GHC2210	<Null>	<Null>	<Null>	3/30/2023
956 Point	CB392	CITY	GHC2108	<Null>	<Null>	<Null>	3/30/2023
957 Point	CB393	CITY	GHC2108	<Null>	<Null>	<Null>	3/30/2023
958 Point	CB394	CITY	GHC2108	<Null>	<Null>	<Null>	3/30/2023
960 Point	CB396	CITY	GHC2108	<Null>	<Null>	<Null>	3/30/2023
961 Point	CB397	CITY	GHC2108	<Null>	<Null>	<Null>	3/30/2023
964 Point	CB400	CITY	GHC2108	<Null>	<Null>	<Null>	3/30/2023
981 Point	CB417	CITY	GHC2210	<Null>	<Null>	<Null>	3/30/2023
982 Point	CB418	CITY	GHC2210	<Null>	<Null>	<Null>	3/30/2023
983 Point	CB419	CITY	GHC2210	<Null>	<Null>	<Null>	3/30/2023
984 Point	CB420	CITY	GHC2210	<Null>	<Null>	<Null>	3/30/2023
987 Point	CB423	CITY	GHC2210	<Null>	<Null>	<Null>	3/30/2023
988 Point	CB424	CITY	GHC2210	<Null>	<Null>	<Null>	3/30/2023
990 Point	CB426	CITY	GHC2210	<Null>	<Null>	<Null>	3/30/2023
991 Point	CB427	CITY	GHC2210	<Null>	<Null>	<Null>	3/30/2023
992 Point	CB428	CITY	GHC2210	<Null>	<Null>	<Null>	3/30/2023
993 Point	CB429	CITY	GHC2210	<Null>	Failing	<Null>	3/30/2023
998 Point	CB434	CITY	GHC2210	<Null>	<Null>	<Null>	3/30/2023
999 Point	CB435	CITY	GHC2210	<Null>	<Null>	<Null>	3/30/2023
1002 Point	CB439	CITY	GHC2210	<Null>	<Null>	<Null>	3/30/2023
1040 Point	CB477	CITY	GHC2108	<Null>	<Null>	<Null>	3/30/2023
1086 Point	CB520	CITY	GHC2112	<Null>	<Null>	<Null>	3/30/2023
1098 Point	CB532	CITY	GHC2108	<Null>	<Null>	<Null>	3/30/2023
1099 Point	CB533	CITY	GHC2108	<Null>	<Null>	<Null>	3/30/2023
1102 Point	CB536	CITY	GHC2108	<Null>	<Null>	<Null>	3/30/2023
1104 Point	CB538	CITY	GHC2108	<Null>	<Null>	<Null>	3/30/2023
1105 Point	CB539	CITY	GHC2108	<Null>	<Null>	<Null>	3/30/2023
1106 Point	CB540	CITY	GHC2108	<Null>	<Null>	<Null>	3/30/2023
1112 Point	CB546	CITY	GHC2108	<Null>	<Null>	<Null>	3/30/2023
1324 Point	CB750	CITY	GHC2112	<Null>	<Null>	<Null>	3/30/2023

1372 Point	CB823	CITY	GHC2804	<Null>	<Null>	<Null>	3/30/2023
1373 Point	CB824	CITY	GHC2804	<Null>	<Null>	<Null>	3/30/2023
1478 Point	CB811	CITY	GHC2112	<Null>	<Null>	<Null>	3/30/2023
1479 Point	CB812	CITY	GHC2112	<Null>	<Null>	<Null>	3/30/2023
1480 Point	CB813	CITY	GHC2112	<Null>	<Null>	<Null>	3/30/2023
1481 Point	CB814	CITY	GHC2112	<Null>	<Null>	<Null>	3/30/2023
1482 Point	CB815	CITY	GHC2112	<Null>	<Null>	<Null>	3/30/2023
1483 Point	CB816	CITY	GHC2112	<Null>	<Null>	<Null>	3/30/2023
315 Point	CB369	CITY	GHC2108	<Null>	<Null>	<Null>	3/29/2023
318 Point	CB372	CITY	GHC2108	<Null>	<Null>	<Null>	3/29/2023
320 Point	CB374	CITY	GHC2108	<Null>	<Null>	<Null>	3/29/2023
322 Point	CB376	CITY	GHC2108	<Null>	<Null>	<Null>	3/29/2023
324 Point	CB378	CITY	GHC2108	<Null>	<Null>	<Null>	3/29/2023
496 Point	CB973	CITY	GHC2112	<Null>	<Null>	<Null>	3/29/2023
497 Point	CB974	CITY	GHC2112	<Null>	<Null>	<Null>	3/29/2023
498 Point	CB975	CITY	GHC2112	<Null>	<Null>	<Null>	3/29/2023
502 Point	CB980	CITY	GHC2112	<Null>	<Null>	<Null>	3/29/2023
503 Point	CB981	CITY	GHC2112	<Null>	<Null>	<Null>	3/29/2023
508 Point	CB986	CITY	GHC2112	<Null>	<Null>	<Null>	3/29/2023
509 Point	CB987	CITY	GHC2112	<Null>	<Null>	<Null>	3/29/2023
510 Point	CB988	CITY	GHC2112	<Null>	<Null>	<Null>	3/29/2023
747 Point	CB1356	CITY	GHC2210	<Null>	<Null>	<Null>	3/29/2023
749 Point	CB1358	CITY	GHC2210	<Null>	<Null>	<Null>	3/29/2023
750 Point	CB1359	CITY	GHC2210	<Null>	<Null>	<Null>	3/29/2023
775 Point	CB1386	CITY	GHC2108	<Null>	<Null>	<Null>	3/29/2023
776 Point	CB1387	CITY	GHC2108	<Null>	<Null>	<Null>	3/29/2023
777 Point	CB1388	CITY	GHC2108	<Null>	<Null>	<Null>	3/29/2023
901 Point	CB743	CITY	GHC2112	<Null>	<Null>	<Null>	3/29/2023
924 Point	CB308	CITY	GHC2210	<Null>	<Null>	<Null>	3/29/2023
927 Point	CB311	CITY	GHC2210	<Null>	<Null>	<Null>	3/29/2023
929 Point	CB313	CITY	GHC2210	<Null>	<Null>	<Null>	3/29/2023
930 Point	CB314	CITY	GHC2210	<Null>	<Null>	<Null>	3/29/2023
931 Point	CB315	CITY	GHC2210	<Null>	<Null>	<Null>	3/29/2023
1006 Point	CB443	CITY	GHC2108	<Null>	<Null>	<Null>	3/29/2023
1007 Point	CB444	CITY	GHC2210	<Null>	<Null>	<Null>	3/29/2023
1010 Point	CB447	CITY	GHC2210	<Null>	<Null>	<Null>	3/29/2023
1011 Point	CB448	CITY	GHC2210	<Null>	<Null>	<Null>	3/29/2023
1012 Point	CB449	CITY	GHC2210	<Null>	<Null>	<Null>	3/29/2023
1013 Point	CB450	CITY	GHC2210	<Null>	<Null>	<Null>	3/29/2023
1014 Point	CB451	CITY	GHC2210	<Null>	<Null>	<Null>	3/29/2023
1016 Point	CB453	CITY	GHC2210	<Null>	<Null>	<Null>	3/29/2023
1022 Point	CB459	CITY	GHC2210	<Null>	<Null>	<Null>	3/29/2023
1027 Point	CB464	CITY	GHC2108	<Null>	<Null>	<Null>	3/29/2023
1108 Point	CB542	CITY	GHC2108	<Null>	<Null>	<Null>	3/29/2023
1109 Point	CB543	CITY	GHC2108	<Null>	<Null>	<Null>	3/29/2023
1110 Point	CB544	CITY	GHC2108	<Null>	<Null>	<Null>	3/29/2023
1111 Point	CB545	CITY	GHC2108	<Null>	<Null>	<Null>	3/29/2023

1117 Point	CB551	CITY	GHC2108	<Null>	<Null>	<Null>	3/29/2023
1118 Point	CB552	CITY	GHC2108	<Null>	<Null>	<Null>	3/29/2023
1119 Point	CB553	CITY	GHC2108	<Null>	<Null>	<Null>	3/29/2023
1120 Point	CB554	CITY	GHC2108	<Null>	<Null>	<Null>	3/29/2023
1122 Point	CB556	CITY	GHC2108	<Null>	<Null>	<Null>	3/29/2023
1123 Point	CB557	CITY	GHC2108	<Null>	<Null>	<Null>	3/29/2023
1127 Point	CB561	CITY	GHC2108	<Null>	<Null>	<Null>	3/29/2023
1265 Point	CB1276	CITY	GHC2112	<Null>	<Null>	<Null>	3/29/2023
1318 Point	CB744	CITY	GHC2112	<Null>	<Null>	<Null>	3/29/2023
1385 Point	CB836	CITY	GHC2112	Broken	<Null>	<Null>	3/29/2023
1454 Point	CB787	CITY	GHC2804	<Null>	<Null>	<Null>	3/29/2023
1468 Point	CB801	CITY	GHC2112	<Null>	<Null>	<Null>	3/29/2023
1469 Point	CB802	CITY	GHC2112	<Null>	<Null>	<Null>	3/29/2023
1472 Point	CB805	CITY	GHC2112	<Null>	<Null>	<Null>	3/29/2023
165 Point	CB171	CITY	GHC2108	<Null>	<Null>	<Null>	3/28/2023
166 Point	CB172	CITY	GHC2108	<Null>	<Null>	<Null>	3/28/2023
168 Point	CB174	CITY	GHC2108	<Null>	<Null>	<Null>	3/28/2023
171 Point	CB177	CITY	GHC2108	<Null>	<Null>	<Null>	3/28/2023
175 Point	CB181	CITY	GHC2112	<Null>	<Null>	<Null>	3/28/2023
176 Point	CB182	CITY	GHC2111	<Null>	<Null>	<Null>	3/28/2023
182 Point	CB185	CITY	GHC2111	<Null>	<Null>	<Null>	3/28/2023
189 Point	CB192	CITY	GHC2111	<Null>	<Null>	<Null>	3/28/2023
214 Point	CB217	CITY	GHC2108	<Null>	<Null>	<Null>	3/28/2023
215 Point	CB218	CITY	GHC2108	<Null>	<Null>	<Null>	3/28/2023
218 Point	CB221	CITY	GHC2112	<Null>	<Null>	<Null>	3/28/2023
220 Point	CB224	CITY	GHC2108	<Null>	<Null>	<Null>	3/28/2023
222 Point	CB226	CITY	GHC2108	<Null>	<Null>	<Null>	3/28/2023
287 Point	CB341	CITY	GHC2111	<Null>	<Null>	<Null>	3/28/2023
289 Point	CB343	CITY	GHC2111	<Null>	<Null>	<Null>	3/28/2023
521 Point	CB999	CITY	GHC2112	<Null>	<Null>	<Null>	3/28/2023
698 Point	CB1176	CITY	GHC2112	<Null>	<Null>	<Null>	3/28/2023
699 Point	CB1177	CITY	GHC2112	<Null>	<Null>	<Null>	3/28/2023
700 Point	CB1178	CITY	GHC2112	<Null>	<Null>	<Null>	3/28/2023
704 Point	CB1182	CITY	GHC2112	<Null>	<Null>	<Null>	3/28/2023
705 Point	CB1183	CITY	GHC2112	<Null>	<Null>	<Null>	3/28/2023
706 Point	CB1184	CITY	GHC2112	<Null>	<Null>	<Null>	3/28/2023
708 Point	CB1186	CITY	GHC2112	<Null>	<Null>	<Null>	3/28/2023
766 Point	CB1377	CITY	GHC2108	<Null>	<Null>	<Null>	3/28/2023
767 Point	CB1378	CITY	GHC2108	<Null>	<Null>	<Null>	3/28/2023
769 Point	CB1380	CITY	GHC2108	<Null>	<Null>	<Null>	3/28/2023
771 Point	CB1382	CITY	GHC2108	<Null>	<Null>	<Null>	3/28/2023
1026 Point	CB463	CITY	GHC2108	<Null>	<Null>	<Null>	3/28/2023
1031 Point	CB468	CITY	GHC2111	<Null>	<Null>	<Null>	3/28/2023
1034 Point	CB471	CITY	GHC2111	<Null>	<Null>	<Null>	3/28/2023
1126 Point	CB560	CITY	GHC2108	<Null>	<Null>	<Null>	3/28/2023
1136 Point	CB570	CITY	GHC2108	<Null>	<Null>	<Null>	3/28/2023
1137 Point	CB571	CITY	GHC2108	<Null>	<Null>	<Null>	3/28/2023

1138 Point	CB572	CITY	GHC2108	<Null>	<Null>	<Null>	3/28/2023
1140 Point	CB574	CITY	GHC2108	<Null>	<Null>	<Null>	3/28/2023
1141 Point	CB575	CITY	GHC2108	<Null>	<Null>	<Null>	3/28/2023
1142 Point	CB576	CITY	GHC2108	<Null>	<Null>	<Null>	3/28/2023
1148 Point	CB582	CITY	GHC2112	<Null>	<Null>	<Null>	3/28/2023
1221 Point	CB1233	CITY	GHC2112	<Null>	<Null>	<Null>	3/28/2023
1290 Point	CB1303	CITY	GHC2108	Good	<Null>	<Null>	3/28/2023
1291 Point	CB1304	CITY	GHC2108	<Null>	<Null>	<Null>	3/28/2023
1397 Point	CB848	CITY	GHC2024	<Null>	<Null>	<Null>	3/28/2023
1462 Point	CB795	CITY	GHC2024	<Null>	<Null>	<Null>	3/28/2023
1463 Point	CB796	CITY	GHC2024	<Null>	<Null>	<Null>	3/28/2023
1464 Point	CB797	CITY	GHC2024	<Null>	<Null>	<Null>	3/28/2023
1489 Point	CB1503	CITY	GHC2108	<Null>	<Null>	<Null>	3/28/2023
1494 Point	CB1508	CITY	GHC2108	<Null>	<Null>	<Null>	3/28/2023
207 Point	CB210	CITY	GHC2108	<Null>	<Null>	<Null>	3/27/2023
208 Point	CB211	CITY	GHC2108	<Null>	<Null>	<Null>	3/27/2023
209 Point	CB212	CITY	GHC2108	<Null>	<Null>	<Null>	3/27/2023
353 Point	CB647	CITY	GHC2804	<Null>	<Null>	<Null>	3/27/2023
355 Point	CB649	CITY	GHC2804	<Null>	<Null>	<Null>	3/27/2023
356 Point	CB650	CITY	GHC2804	<Null>	<Null>	<Null>	3/27/2023
357 Point	CB651	CITY	GHC2804	<Null>	<Null>	<Null>	3/27/2023
358 Point	CB652	CITY	GHC2804	<Null>	<Null>	<Null>	3/27/2023
359 Point	CB653	CITY	GHC2804	<Null>	<Null>	<Null>	3/27/2023
367 Point	CB661	CITY	GHC2804	<Null>	<Null>	<Null>	3/27/2023
369 Point	CB663	CITY	GHC2804	<Null>	<Null>	<Null>	3/27/2023
370 Point	CB664	CITY	GHC2804	<Null>	<Null>	<Null>	3/27/2023
371 Point	CB665	CITY	GHC2804	<Null>	<Null>	<Null>	3/27/2023
372 Point	CB666	CITY	GHC2804	<Null>	<Null>	<Null>	3/27/2023
382 Point	CB674	CITY	GHC2804	<Null>	<Null>	<Null>	3/27/2023
383 Point	CB675	CITY	GHC2804	<Null>	<Null>	<Null>	3/27/2023
384 Point	CB676	CITY	GHC2804	<Null>	<Null>	<Null>	3/27/2023
488 Point	CB965	CITY	GHC2024	<Null>	<Null>	<Null>	3/27/2023
489 Point	CB966	CITY	GHC2024	<Null>	<Null>	<Null>	3/27/2023
490 Point	CB967	CITY	GHC2024	<Null>	<Null>	<Null>	3/27/2023
491 Point	CB968	CITY	GHC2024	<Null>	<Null>	<Null>	3/27/2023
492 Point	CB969	CITY	GHC2024	<Null>	<Null>	<Null>	3/27/2023
511 Point	CB989	CITY	GHC2112	<Null>	<Null>	<Null>	3/27/2023
529 Point	CB1008	CITY	GHC2804	<Null>	<Null>	<Null>	3/27/2023
531 Point	CB1009	CITY	GHC2804	<Null>	<Null>	<Null>	3/27/2023
532 Point	CB1010	CITY	GHC2804	<Null>	<Null>	<Null>	3/27/2023
579 Point	CB1057	CITY	GHC2112	<Null>	<Null>	<Null>	3/27/2023
580 Point	CB1058	CITY	GHC2024	<Null>	<Null>	<Null>	3/27/2023
581 Point	CB1059	CITY	GHC2024	<Null>	<Null>	<Null>	3/27/2023
583 Point	CB1061	CITY	GHC2024	<Null>	<Null>	<Null>	3/27/2023
584 Point	CB1062	CITY	GHC2024	<Null>	<Null>	<Null>	3/27/2023
586 Point	CB1064	CITY	GHC2024	<Null>	<Null>	<Null>	3/27/2023
587 Point	CB1065	CITY	GHC2024	<Null>	<Null>	<Null>	3/27/2023

591 Point	CB1069	CITY	GHC2024	<Null>	<Null>	<Null>	3/27/2023
592 Point	CB1070	CITY	GHC2024	<Null>	<Null>	<Null>	3/27/2023
616 Point	CB1094	CITY	GHC2112	<Null>	<Null>	<Null>	3/27/2023
618 Point	CB1096	CITY	GHC2112	<Null>	<Null>	<Null>	3/27/2023
619 Point	CB1097	CITY	GHC2112	<Null>	<Null>	<Null>	3/27/2023
622 Point	CB1101	CITY	GHC2024	<Null>	<Null>	<Null>	3/27/2023
623 Point	CB1102	CITY	GHC2024	<Null>	<Null>	<Null>	3/27/2023
624 Point	CB1103	CITY	GHC2004	<Null>	<Null>	<Null>	3/27/2023
627 Point	CB1105	CITY	GHC2004	<Null>	<Null>	<Null>	3/27/2023
628 Point	CB1106	CITY	GHC2004	<Null>	<Null>	<Null>	3/27/2023
629 Point	CB1107	CITY	GHC2004	<Null>	<Null>	<Null>	3/27/2023
630 Point	CB1108	CITY	GHC2004	<Null>	<Null>	<Null>	3/27/2023
685 Point	CB1163	CITY	GHC2003	<Null>	<Null>	<Null>	3/27/2023
686 Point	CB1164	CITY	GHC2003	<Null>	<Null>	<Null>	3/27/2023
692 Point	CB1170	CITY	GHC2112	<Null>	<Null>	<Null>	3/27/2023
693 Point	CB1171	CITY	GHC2112	<Null>	<Null>	<Null>	3/27/2023
694 Point	CB1172	CITY	GHC2112	<Null>	<Null>	<Null>	3/27/2023
696 Point	CB1174	CITY	GHC2112	<Null>	<Null>	<Null>	3/27/2023
697 Point	CB1175	CITY	GHC2112	<Null>	<Null>	<Null>	3/27/2023
709 Point	CB1187	CITY	GHC2106	<Null>	<Null>	<Null>	3/27/2023
710 Point	CB1188	CITY	GHC2106	<Null>	<Null>	<Null>	3/27/2023
711 Point	CB1189	CITY	GHC2106	<Null>	<Null>	<Null>	3/27/2023
712 Point	CB1190	CITY	GHC2106	<Null>	<Null>	<Null>	3/27/2023
781 Point	CB1392	CITY	GHC2108	<Null>	<Null>	<Null>	3/27/2023
782 Point	CB1393	CITY	GHC2108	<Null>	<Null>	<Null>	3/27/2023
784 Point	CB1397	CITY	GHC2804	<Null>	<Null>	<Null>	3/27/2023
830 Point	CB1443	CITY	GHC2112	<Null>	<Null>	<Null>	3/27/2023
832 Point	CB1445	CITY	GHC2112	<Null>	<Null>	<Null>	3/27/2023
892 Point	CB618	CITY	GHC2804	<Null>	<Null>	<Null>	3/27/2023
893 Point	CB619	CITY	GHC2804	<Null>	<Null>	<Null>	3/27/2023
1339 Point	CB765	CITY	GHC2804	<Null>	<Null>	<Null>	3/27/2023
1341 Point	CB767	CITY	GHC2804	<Null>	<Null>	<Null>	3/27/2023
1384 Point	CB835	CITY	GHC2804	<Null>	<Null>	<Null>	3/24/2023
1663 Point	CB1635	CITY	GHC2112	New	<Null>	<Null>	3/6/2023
1664 Point	CB1636	CITY	GHC2112	New	<Null>	<Null>	3/6/2023
1667 Point	CB1638	CITY	GHC2112	New	<Null>	<Null>	3/6/2023
1669 Point	CB1640	CITY	GHC2112	New	<Null>	<Null>	3/6/2023
186 Point	CB189	CITY	GHC2111	<Null>	<Null>	<Null>	2/21/2023
187 Point	CB190	CITY	GHC2111	<Null>	<Null>	<Null>	2/21/2023
188 Point	CB191	CITY	GHC2111	<Null>	<Null>	<Null>	2/21/2023
204 Point	CB207	CITY	GHC2111	<Null>	<Null>	<Null>	2/21/2023
206 Point	CB209	CITY	GHC2111	<Null>	<Null>	<Null>	2/21/2023
221 Point	CB225	CITY	GHC2111	<Null>	<Null>	<Null>	2/21/2023
760 Point	CB1371	CITY	GHC2111	<Null>	<Null>	<Null>	2/21/2023
823 Point	CB1436	CITY	GHC2106	<Null>	<Null>	<Null>	2/21/2023
824 Point	CB1437	CITY	GHC2106	<Null>	<Null>	<Null>	2/21/2023
826 Point	CB1439	CITY	GHC2106	<Null>	<Null>	<Null>	2/21/2023

828 Point	CB1441	CITY	GHC2106	<Null>	<Null>	<Null>	2/21/2023
1244 Point	CB1255	CITY	GHC2106	<Null>	<Null>	<Null>	2/21/2023
1246 Point	CB1257	CITY	GHC2106	<Null>	<Null>	<Null>	2/21/2023
1248 Point	CB1259	CITY	GHC2106	<Null>	<Null>	<Null>	2/21/2023
1249 Point	CB1260	CITY	GHC2106	<Null>	<Null>	<Null>	2/21/2023
1250 Point	CB1261	CITY	GHC2106	<Null>	<Null>	<Null>	2/21/2023
1522 Point	CB1537	<Null>	GHC2106	<Null>	<Null>	<Null>	2/21/2023
1592 Point	CB1606	<Null>	<Null>	Good	<Null>	<Null>	2/21/2023
1645 Point	CB1618	CITY	GHC2106	New	<Null>	<Null>	2/21/2023
1646 Point	CB1622	CITY	GHC2106	New	<Null>	<Null>	2/21/2023
1647 Point	CB1623	CITY	GHC2106	New	<Null>	<Null>	2/21/2023
1648 Point	CB1619	CITY	GHC2106	New	<Null>	<Null>	2/21/2023
1649 Point	CB1624	CITY	GHC2106	New	<Null>	<Null>	2/21/2023
1650 Point	CB1620	CITY	GHC2106	New	<Null>	<Null>	2/21/2023
1652 Point	CB1625	CITY	GHC2106	New	<Null>	<Null>	2/21/2023
1654 Point	CB1632	CITY	GHC2106	New	<Null>	<Null>	2/21/2023
1655 Point	CB1633	CITY	GHC2106	New	<Null>	<Null>	2/21/2023
1657 Point	CB1628	CITY	GHC2106	New	<Null>	<Null>	2/21/2023
1658 Point	CB1627	CITY	GHC2106	New	<Null>	<Null>	2/21/2023
1659 Point	CB1631	CITY	GHC2106	New	<Null>	<Null>	2/21/2023
1660 Point	CB1629	CITY	GHC2106	New	<Null>	<Null>	2/21/2023
1661 Point	CB1630	CITY	GHC2106	New	<Null>	<Null>	2/21/2023

MS4 Community Annual PEP Checklist

This document outlines your community's required activities for the 2023 Reporting Period. Check the box for each action as you complete it and provide supporting documentation where indicated.

LGROW Dropbox: [Link](#)

Community Name:

City of Grand Haven

- 1. Publish at least 1 **article** on PEP topics in Community newsletter or news outlet (recommended quarterly)

Date	Article	PEP Topic
		Choose an item.
		Choose an item.
		Choose an item.
		Choose an item.

- 2. Community presence or Stormwater Display at 1 event or location

Event Date:

Event Location:

***Attach a photo of event/display; List additional/multiple events at the end of this form**

- 3. Distribute pollution prevention **information** to at least 2 **targeted businesses/groups** listed in PEP

Names of Businesses	Title(s) of Material(s) Distributed

- 4. Share household hazardous waste reduction information with residents via Community's social media, newsletter, or website

Date shared: 05/14/2023

Location shared: Facebook and Instagram

Social Media Post Reach: 18

Social Media Post Engagement: 18



X 5. Distribute giveaway items for selected PEP categories

Item	# Distributed	Item	# Distributed
Troutie Coloring Book	<u>20</u>	LGROW Brochure Spanish	
LGROW Colored Pencils	<u>10</u>	AAD Tip Cards	
Pet Waste Bag Dispenser	<u>10</u>	Septic Smart Brochures	
LGROW Foldable Bags	<u>20</u>	Septic Smart Brochures Spanish	
LGROW Brochure English		Make your home the solution to stormwater pollution English	
Make your home the solution to stormwater pollution Spanish		EPA Stormwater Smart Construction in your Neighborhood	
EPA Stormwater Smart Restaurants		EPA Stormwater Smart Parking Lots	
EPA Stormwater Smart Lawn Care		EPA Stormwater Smart Auto Shops	
EPA Stormwater Smart Construction Sites		Salt Tip Card	
LGROW Tip Cards			

Other Activities

6. Host, participate in, or support a stream cleanup effort

Cleanup Date: 04/22/2023

Cleanup Location: Grand Haven State Park

of Volunteers: Unknown

***Attach a copy of volunteer sign-in sheets or photos**



7. Join or Promote Adopt a Drain Program

Date(s) of program promotion:

Method of program promotion:

Social Media Metrics (Post Reach, Post Engagement):

***LGROW will create a report of the number of drains adopted in your Community**

8. Provide presentation on PEP topics to a school in your Community

Please add teacher contact information if you are interested in having LGROW work with your local school:

Teacher Name & Contact Information	School District

9. Implement EPA SepticSmart Social Media Guide during SepticSmart Week: **September 18-22, 2023**

Provide Social Media Metrics (Post Reach, Post Engagement):

☒ 10. Share social media posts provided by LGROW

Date	Post Title/ PEP Topic	Social Media Type
11/27/2023	Store Salt Safely	Facebook
11/20/2023	Clear Storm Drains	Facebook
10/27/2023	Wait to Prune Plants	Facebook
9/29/2023	Compost Leaves	Facebook
8/18/2023	Clear Storm Drains	Facebook
6/25/2023	Summer Tips	Facebook
6/11/2023	Carwash Tips	Facebook

Other Public Engagement Activities Completed

Use this space to provide additional detail on Public Engagement Activities described above or to describe other Public Engagement Activities completed in your Community during the reporting period.

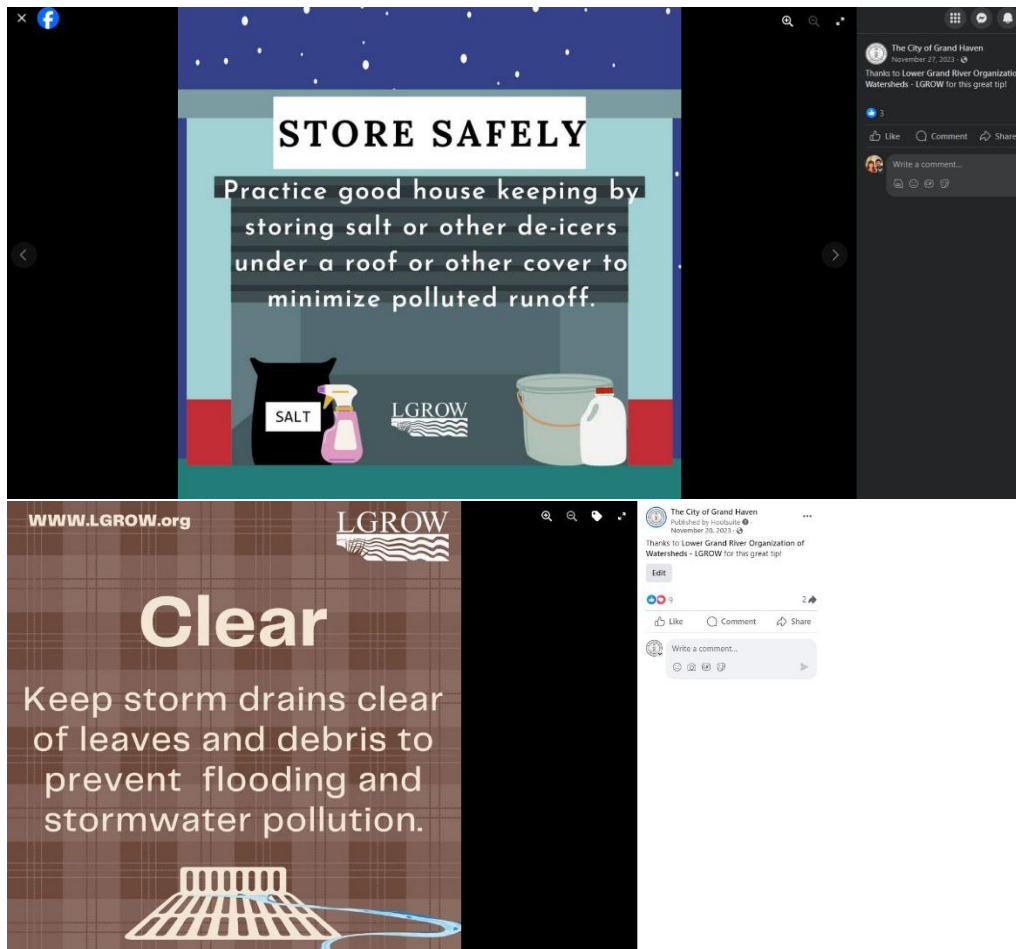

WWW.LGROW.org

LGROW



Prune

Wait to prune until late spring to preserve habitats for pollinators!



The City of Grand Haven
Published by Hootsuite
October 27, 2023

Thanks, Lower Grand River Organization of Watersheds - LGROW, for this great tip!

Edit

18

Like Comment Share

Write a comment...

WWW.LGROW.org

LGROW



Compost

Compost leaves and other organic waste to make your own soil additives for later use.

The City of Grand Haven
September 28, 2023

Thanks, Lower Grand River Organization of Watersheds - LGROW, for this great tip!

6

Like Comment Share

Write a comment...

WWW.LGROW.org

LGROW

Clear

Keep storm drains clear of leaves and debris to prevent flooding and stormwater pollution.



The City of Grand Haven
August 18, 2023

Thanks, Lower Grand River Organization of Watersheds - LGROW, for this great tip!

6

Like Comment Share

Write a comment...

LGROW'S

Summer Tips

PROTECT OUR WATERSHED!

Tip #6



Only water lawns when necessary. Lawns need only about 1" of water a week, so be sure to take advantage of the rain. A native plant lawn may require even less water and maintenance.

LGROW

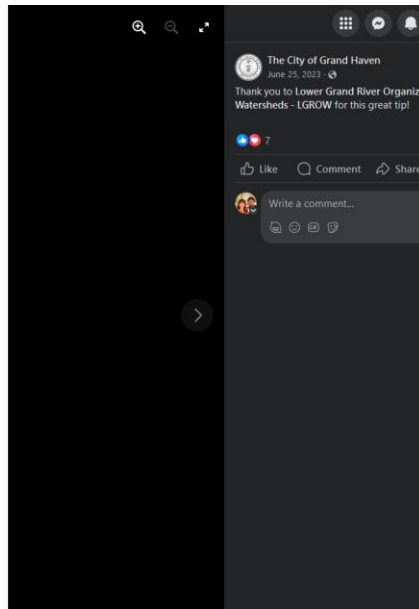

The City of Grand Haven
June 25, 2023 · 7 likes

Thank you to Lower Grand River Organiza Watersheds - LGROW for this great tip!

Like Comment Share

Write a comment...

LGROW'S

Summer Tips

PROTECT OUR WATERSHED!

Tip #5

Wash cars at commercial car washes where there are sanitary sewers and the water is treated, unlike residential sewers. Washing cars at home sends pollutants into our Watershed.



LGROW

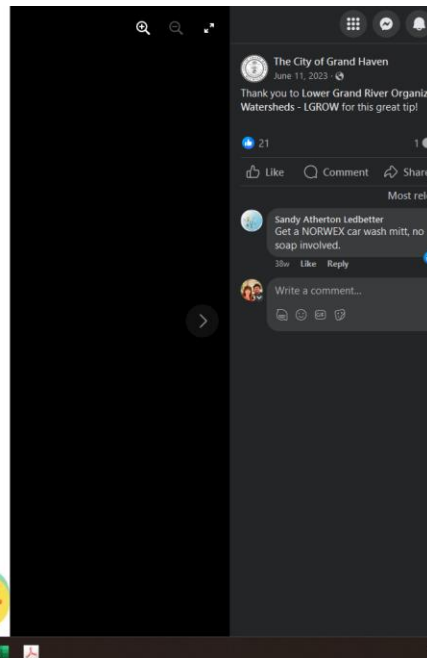

The City of Grand Haven
June 11, 2023 · 21 likes

Thank you to Lower Grand River Organiza Watersheds - LGROW for this great tip!

Like Comment Share

Most relevant

Sandy Atherton Ledbetter
33w · Like · Reply
Get a NORWEX car wash mitt, no soap involved.

Write a comment...